

19-21-247

By the foot of a Ridge

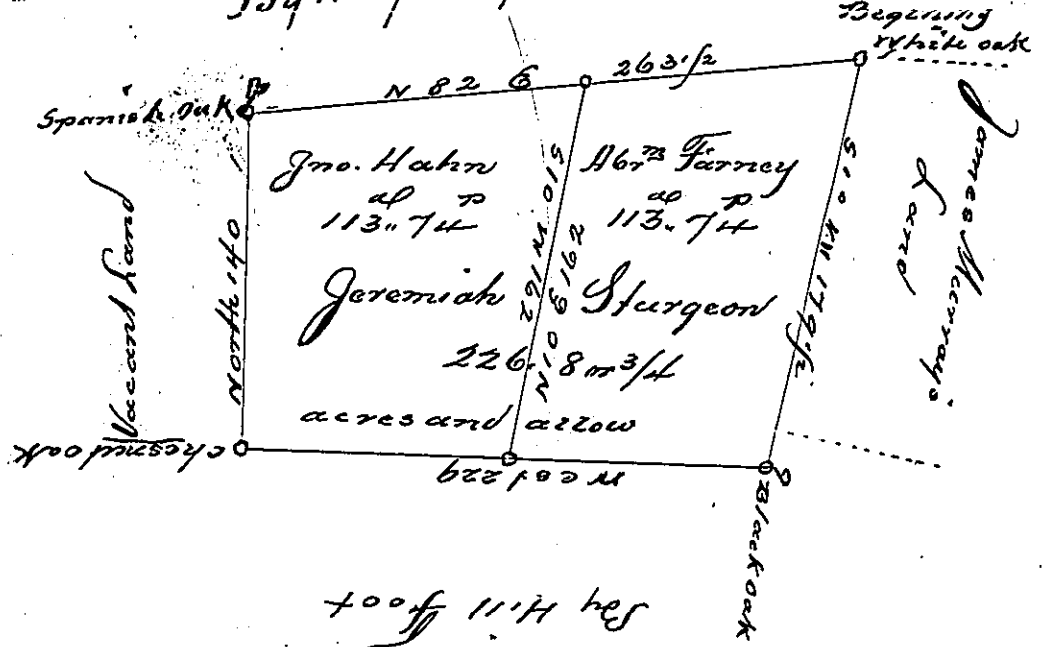

C-15-271

C-137-299

The draught of a Tract of Land Called "Hahn's & Farney's Choice" situate near Cokelamus Creek in the County of Cumberland, Containing Two hundred twenty six acres 148 perches with the usual allowance of six acres p. Cent. for Roads. Survey'd the 5th day April Anno Domini 1764 for Jeremiah Sturgeon. In pursuance of an order of Survey Bearing date at Philad. the 9th day of August Anno Domini 1766 and numbered 827.

P. Wm. MacLayd Jr.

To John Lukens Esq. Secy. of Pennsylvania

In pursuance of sundry mesne grants & Conveyances in law duly had & executed, Jno. Hahn & Abraham Farney became seized in moieties of the above tract of land & have the 24th day of July 1783 caused the same to be divided into two equal parts in the Survey Gen^l Office for obtaining separate patents for the same, which accordingly done.

IN TESTIMONY that the above is a copy of the original remaining on file in the Department of Internal Affairs of Pennsylvania, made conformably to an Act of Assembly approved the 16th day of February, 1833, I have hereunto set my Hand and caused the Seal of said Department to be affixed at Harrisburg, this Seventh day of November 1899



James W. Latta
Secretary of Internal Affairs.